



Addendum No. 1

To: All Contractors
Date: January 11, 2018
Re: Environmental Services Facility – Phase 2
1550 Progress West Ln
O'Fallon, Missouri

The following Drawings, Specifications, Clarifications, Additions or Alterations modify and supersede previously issued documents in reference to the above project. Acknowledge receipt of this Addendum on the Bid Form in the designated location.

IMPORTANT: This addendum and all bidding construction documents represent a comprehensive scope of work. It is each contractor's responsibility to reference all drawings, specifications and addendums to verify their respective scope of work.

GENERAL CLARIFICATIONS:

1. The bid due date remains as Tuesday, January 16, 2018 at 10:00 a.m.
2. Attached is a copy of the Pre-Bid Sign-In sheet.
3. The City of O'Fallon will procure and pay for the permits.
4. The City of O'Fallon does want any concrete, over-dig and soil that will be removed from the site. Follow the instructions in the Job Special Provisions (JSP-22, Item K in the Project Manual).
5. The new fuel tanks will be provided and installed by the city of O'Fallon's current fuel tank provider.
6. Concrete mix designs need submitted and approved to EMPC as stated in the Project Manual, Job Special Provisions (JSP-20, Item j.).

CIVIL CLARIFICATIONS:

1. Sheet 4 of 10, Site Plan (No Drawing Issue)
 - a. Revised the new concrete depth from 7-inches to 8-inches. "New 8" concrete over 4" rock." Also see 8" Concrete Pavement Detail on sheet 9 of 10.
 - b. For bidding purposes, the three (3) electrical conduits are to be located per the Site Plan. For electrical connections, the existing electrical panels are located in the Southwest portion of the building.
2. Sheet 9 of 10, Details. (No drawing Issue)
 - a. There is one (1) Light/Light standard in the scope of work. Provide and install the same type of light/light standard as was installed in the recently completed Phase 1 project. See attached Light/Light Standard Detail.

ELECTRICAL CLARIFICATIONS:

1. Added two (2) new 8x11 Supplemental Sheets.
 - a. Sheet E1, Light / Light Standard containing the Light Fixture information and Pole Base Detail.
 - b. Sheet E2, General Electrical Requirements Notes.

End of Addendum No. 1

Sincerely,

John K. Luehrs
Project Manager

LIGHT FIXTURE

Qty	Description	Mtg.	Lamp Type	Volt	Manufacturer/Catalog No.
1	Fuel Island Light	Pole	LED	208	LUMARK PRV-A40-D-UNV-T4-BZ

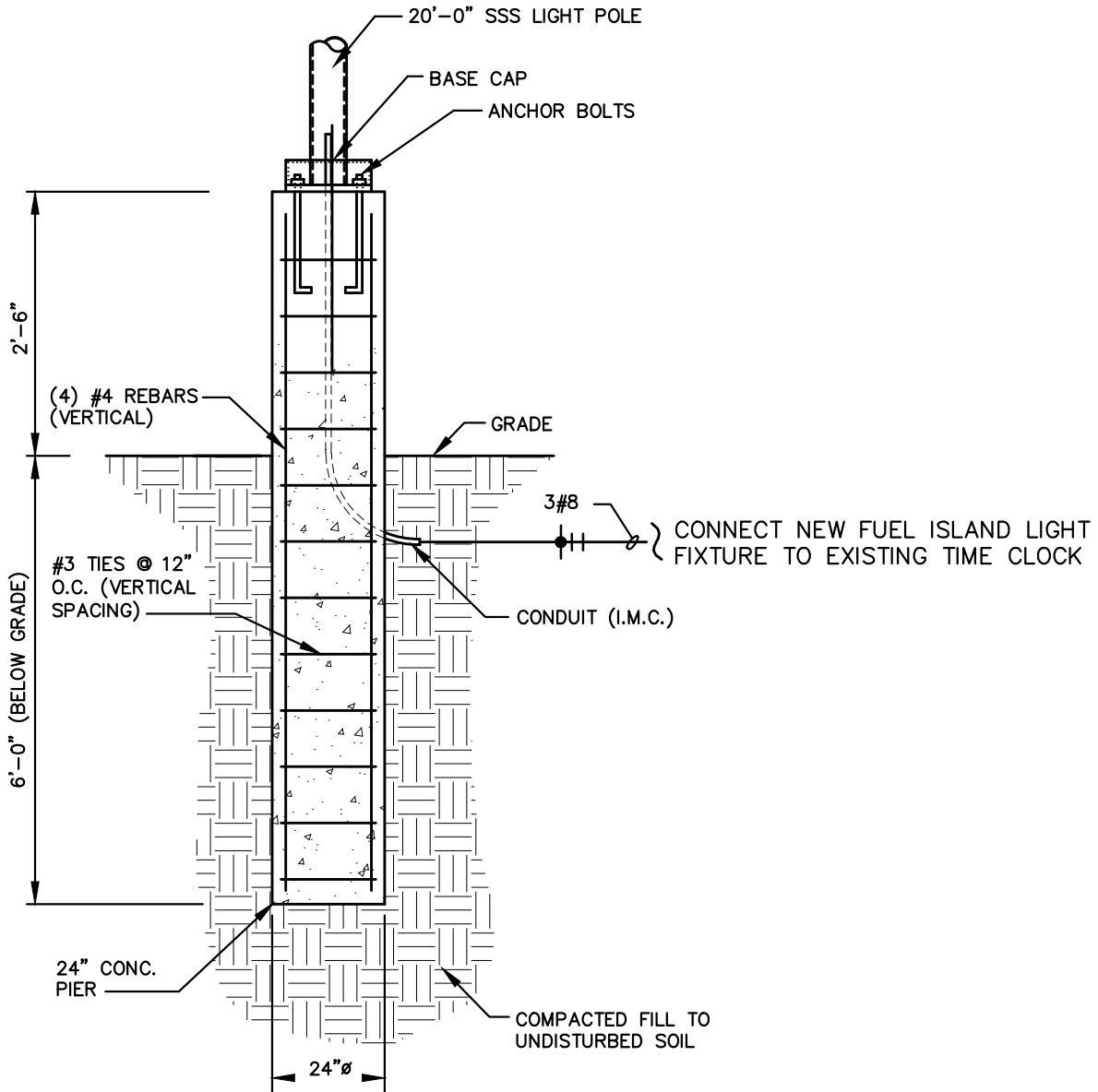

POLE BASE DETAIL

SCALE: NO SCALE

COPYRIGHT © 2018 FACILITY ENGINEERING SERVICES

FACILITY ENGINEERING SERVICES
 MECHANICAL-PLUMBING-ELECTRICAL ENGINEERS
 13067 Winding Trail Lane
 St. Louis, MO 63131
 Ph. 314-799-6163

New Paving and Fuel Island for:
City of O'Fallon
 Environmental Services - Phase 2
 1550 Progress West
 O'Fallon, Missouri 63366

DATE
 1-11-2018

SHEET
E1

GENERAL REQUIREMENTS FOR ELECTRICAL WORK:

1. COMPLY WITH NATIONAL ELECTRICAL CODE 2014, NFPA 70. COMPLY WITH STATE AND LOCAL LAWS, ORDINANCES AND CODES.
2. OBTAIN PERMITS NECESSARY FOR THE ELECTRICAL WORK. CITY OF O'FALLON TO PAY FOR PERMITS.
3. PROVIDE GROUNDING CONDUCTORS IN ALL BRANCH AND FEEDER CIRCUITS.
4. PROVIDE TYPED PANEL SCHEDULES IN EACH BRANCH CIRCUIT PANEL. PROVIDE ENGRAVED PLASTIC NAME PLATE ON FRONT OF EACH ELECTRICAL PANEL.
5. VERIFY ELECTRICAL REQUIREMENTS FOR EQUIPMENT AND OTHER EQUIPMENT WITH THE EQUIPMENT SUPPLIER. PROVIDE WIRING AS REQUIRED FOR THE EXACT EQUIPMENT TO BE INSTALLED. THE EQUIPMENT SUPPLIER SHALL PAY FOR CHANGES IN ELECTRICAL REQUIREMENTS DUE TO CHANGES MADE BY THE EQUIPMENT SUPPLIER. THIS APPLIES TO EQUIPMENT FURNISHED BY OTHER CONTRACTORS OR BY THE OWNER.
6. PROVIDE COMMON TRIP ON CIRCUIT BREAKERS FOR MUTI-WIRE BRANCH CIRCUITS.
7. HOME RUNS LONGER THAN 75'-0" SHALL BE #10. HOME RUNS LONGER THAN 125'-0" SHALL BE #8.

ELECTRICAL MATERIALS

1. ELECTRICAL MATERIALS SHALL BE NEW, AND SHALL HAVE A UL / NRTL LABEL. MATERIALS SHALL COMPLY WITH THE APPLICABLE STANDARDS OF NEMA, ANSI, AND IEEE.
2. CONDUCTORS SHALL BE COPPER, THHN/THWN.
3. WIRING SHALL COMPLY WITH NEC CLASS 1, DIVISION 2.
4. OUTLET BOXES SHALL BE GALVANIZED STEEL OR PVC, SIZE AS REQUIRED FOR APPLICATION AND CONDUCTOR QUANTITY.
5. EXPOSED EXTERIOR CONDUIT SHALL BE IMC. EXTERIOR UNDERGROUND CONDUIT SHALL BE SCHEDULE 40 PVC.
6. BRANCH CIRCUIT PANELS SHALL BE EATON TYPE PRL OR EQUAL BY GENERAL ELECTRIC OR SQUARE D. PANEL VOLTAGE RATING SHALL BE AS REQUIRED FOR SYSTEM USE.
7. FLUORESCENT LIGHTING FIXTURES SHALL HAVE ELECTRONIC BALLASTS, 20% THD.

COPYRIGHT © 2018 FACILITY ENGINEERING SERVICES

FACILITY ENGINEERING SERVICES

MECHANICAL-PLUMBING-ELECTRICAL ENGINEERS
13067 Winding Trail Lane
St. Louis, MO 63131
Ph. 314-799-6163

New Paving and Fuel Island for:

City of O'Fallon
Environmental Services - Phase 2
1550 Progress West
O'Fallon, Missouri 63366

DATE
1-11-2018

SHEET
E2